

## IE; Blinds FIRE ULTRA 60

### CLASSIFICATION

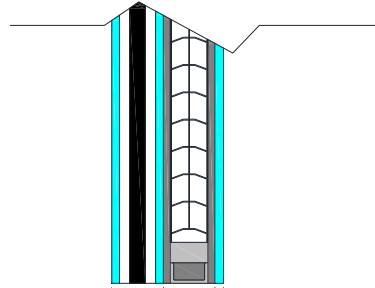

### PRODUCT FEATURES



### Technical Specification

<b>Fire Rating</b>	<b>60 min. Fire-Protection-Rated</b>		
<b>Testing/ Standard Conformity</b>	UL 9, 10b, 10c   NFPA 80/252/257   ASTM N/A   CAN/ULC-S104, S106		
<b>Building Code Market</b>	D-H-T-90, OH-90		
<b>Impact Safety Rating</b>	CPSC 16CFR 1201-CAT II; CAN/CGSB-12.1-M		
<b>Nominal FR Glass Thickness</b>	3/4"		
<b>Overall Nominal Unit Thickness</b>	1-5/8"	1-11/16"	1-3/4"
<b>Tolerance (in.; mm)</b>	+1/8" to -1/16"	(+3mm to -1.5mm)	
<b>U-Value (BTU/hr*sq.ft*°F)</b>	0.39		
<b>STC Rating (dB)</b>	40		
<b>Visible Light Transmission (%)</b>	0-74		
<b>Weight (in.: mm)</b>	11.0"	(54.0mm)	
<b>Groove (in.: mm)</b>	Depth: 5/8"	(16mm)	Width: 1-5/8" (41mm)

### Maximum Dimensions

	Window, Transom Sidelight		Door Non-Temp Rise		Door Temp Rise	
<b>Maximum Exposed Height (in.; m)</b>	76	(1.93)	76	(1.93)	76	(1.93)
<b>Maximum Exposed Width (in.; m)</b>	60-1/2	(1.54)	46-1/2	(1.18)	46-1/2	(1.18)
<b>Maximum Exposed Area (in.<sup>2</sup>; m<sup>2</sup>)</b>	2,736	(1.77)	2,736	(1.77)	2,736	(1.77)